

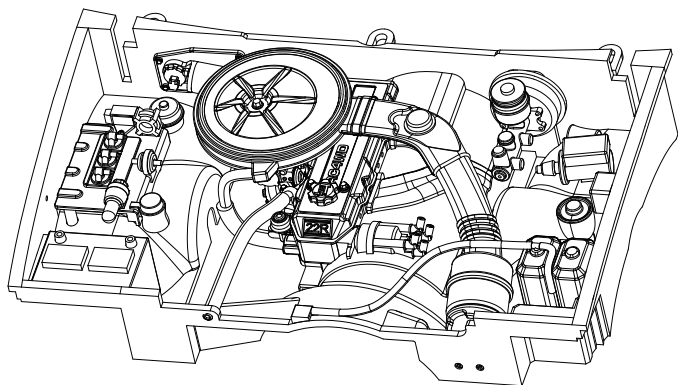

# **RC4WD YOTA 22R ENGINE BAY FOR 1982 TOYOTA PICKUP**



## ***Instruction Manual Symbols Key***



CA Glue



Trim with Hobby Knife



Attention



Cut with Scissors



Drill Hole



Paint



Body Reamer

## ***Recommended Tools***

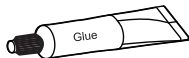

(Foam safe CA, Shoe Goo, E6000, Styrene Glue, Epoxy)

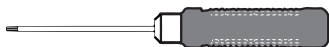

Hex Drivers (1.5mm, 2mm)

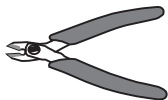

Side Cutters



Hobby Knife



## ***Tips for Assembly***

1. Use good quality hex drivers to avoid stripping screw heads.
2. Use "Step" index for quantity and size of hardware to be used for assembly
3. Do not overtighten screws.
4. Carefully remove all pieces from parts trees with a hobby knife or side cutters. Take care to trim the injection point from the parts.
5. Test fit everything before gluing. Many areas will require extra attention to detail to ensure proper alignment.

## ***Warranty***

RC4WD non-electrical products are warranted to be free of defects in materials and workmanship when new. Our limited warranty does not cover damages due to normal wear and tear, user error of assembly or installation, user modifications, user's failure to perform routine maintenance, addition of aftermarket parts or option parts. This warranty lasts 30 days after arrival for original purchaser.

In the event of a defect under this warranty, RC4WD will, at our discretion, replace the product, provided our inspection indicates that an original defect exists. RC4WD reserves the right to replace any product which is no longer available with a product of comparable value and function. If RC4WD determines the repair is not covered under warranty guidelines, we will contact you to discuss your options. If you have any questions, please contact us via email at [support@rc4wd.com](mailto:support@rc4wd.com).

RC4WD warrants its electronics for 30 days from date of arrival. This covers all electrical items except items that are already noted on the individual product page.

# Parts List-1

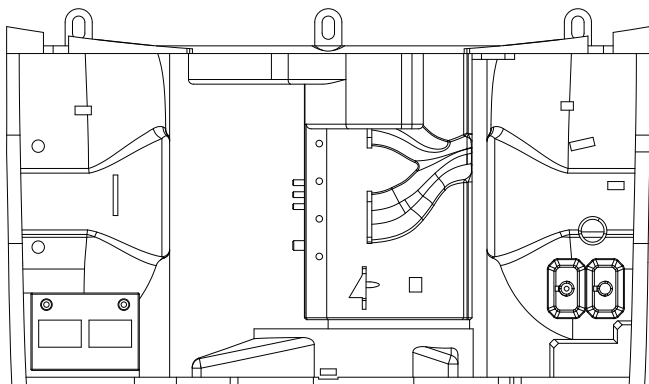

325-1483

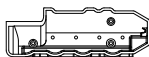

325-1484



325-1485

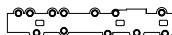

325-1486



325-1487



325-1488

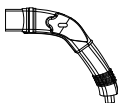

325-1489



325-1490



325-1491



325-1492



325-1493



325-1494



325-1495



325-1496



325-1497



325-1498



325-1499



325-1500



325-1501



325-1502

## Parts List-2

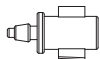

325-1503



325-1504



325-1505



325-1506



325-1507



325-1508



325-1509



325-1510



325-1511



325-1512



325-1513



325-1514



325-1515



325-1516



325-1517



325-1518



325-1519



325-1520



325-1521



325-1522



X3  
SHCS  
M1.4 x 3mm



X1  
SHCS  
M1.4 x 5mm



X1  
Hex Bolts  
M2 x 4mm



X4  
SHSTS  
M1.6 x 4mm



X2  
SHSTS  
M1.6 x 6mm



X4  
SHSTS  
M2 x 6mm



X4  
Z-S1759  
M1.6 x 5mm Hex Bolts



X2  
Z-S1771  
M2.5 x 5mm Set Screw



X1  
Set Screw  
M3 x 8mm

150mm / Ø2mm

Rubber (Black)

50mm / Ø3mm

Rubber (Black)

100mm / Ø4mm

Rubber (Black)



## RC4WD Yota 22R Engine Bay for 1982 Toyota Pickup

Step 1.

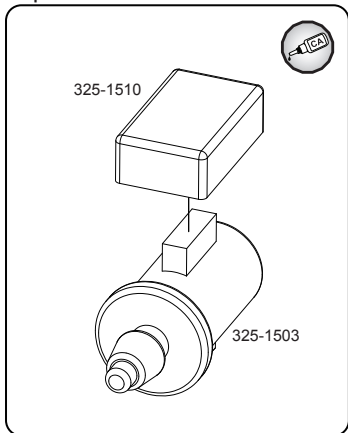

Step 2.

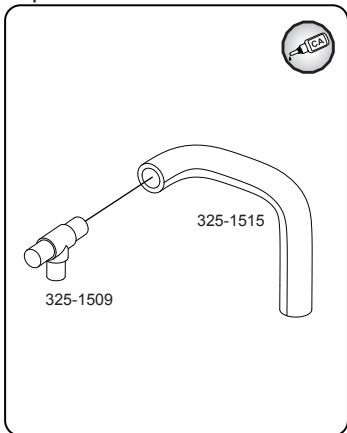

Step 3.

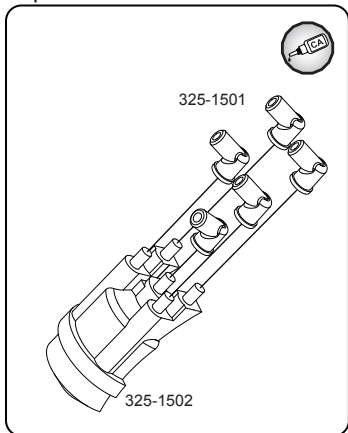

Step 4.

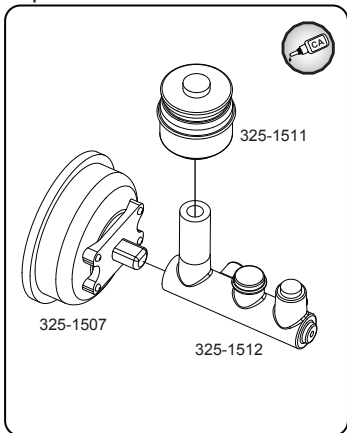



## RC4WD Yota 22R Engine Bay for 1982 Toyota Pickup

Step 5.

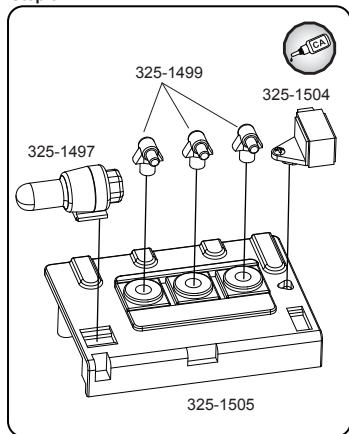

Step 6.

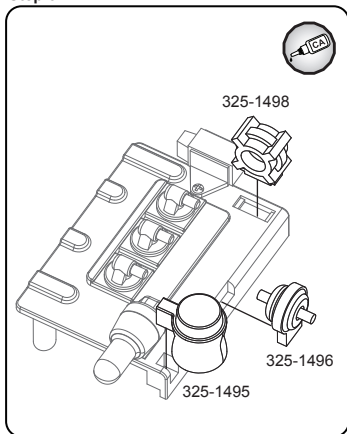

Step 7.

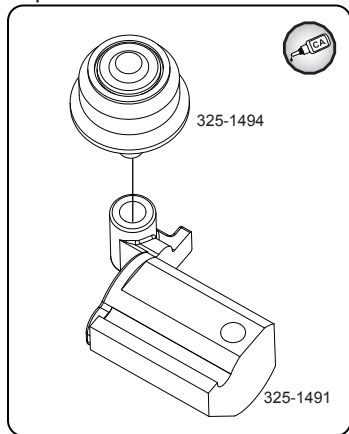

Step 8.

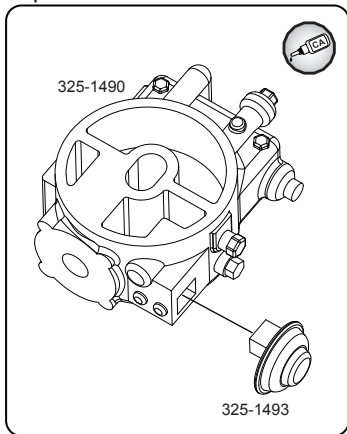



# RC4WD Yota 22R Engine Bay for 1982 Toyota Pickup

Step 9.

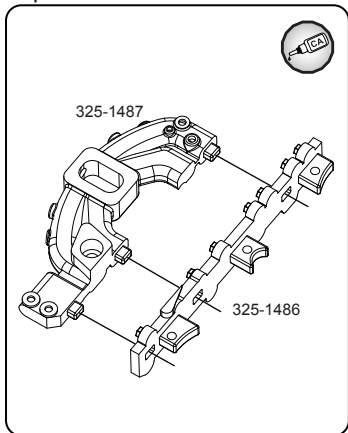

Step 10.

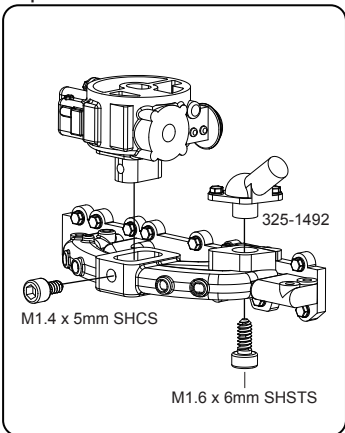

Step 11.

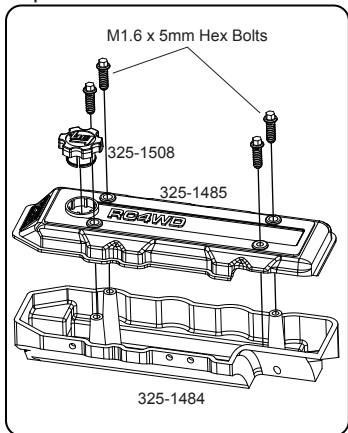

Step 12.

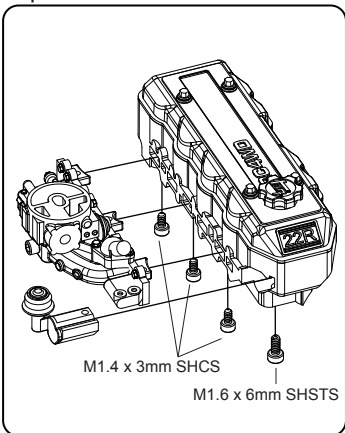



## RC4WD Yota 22R Engine Bay for 1982 Toyota Pickup

Step 13.

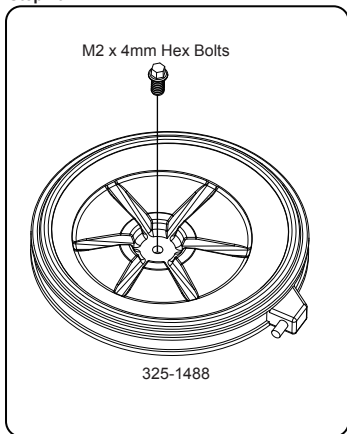

Step 14.

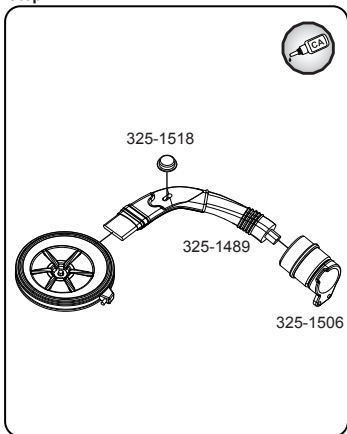

Step 15.

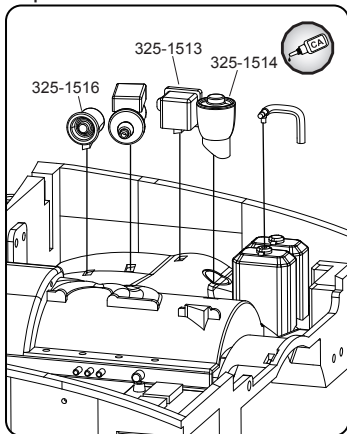

Step 16.

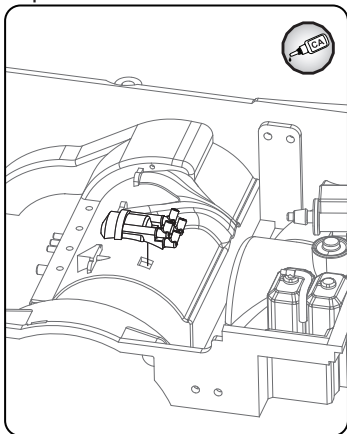



# RC4WD Yota 22R Engine Bay for 1982 Toyota Pickup

Step 17.

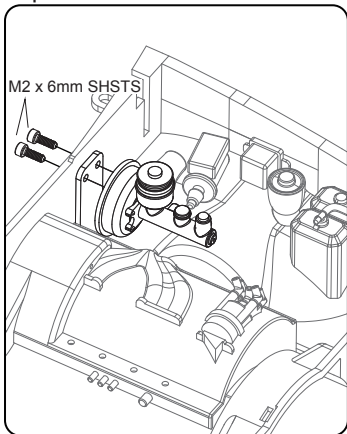

Step 18.

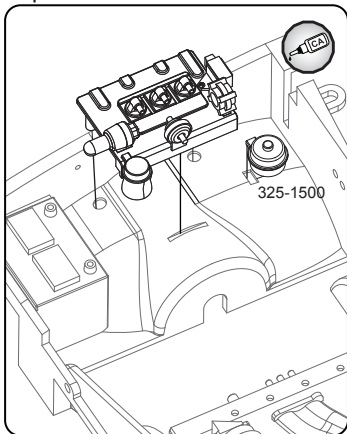

Step 19.

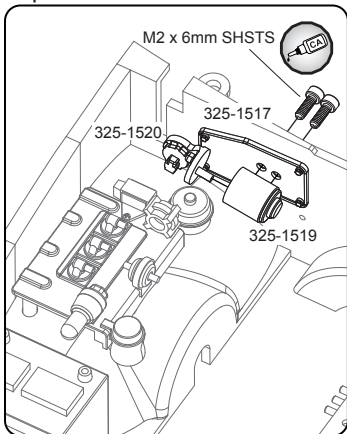

Step 20.

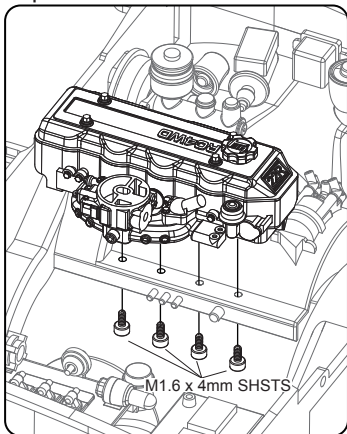





## RC4WD Yota 22R Engine Bay for 1982 Toyota Pickup

### Step 21.

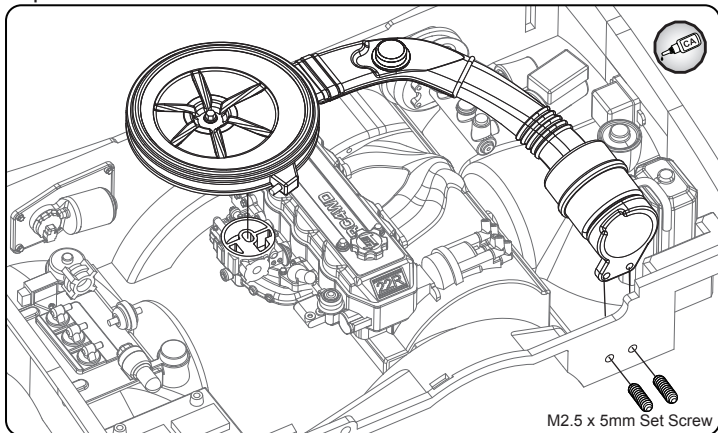

### Step 22.

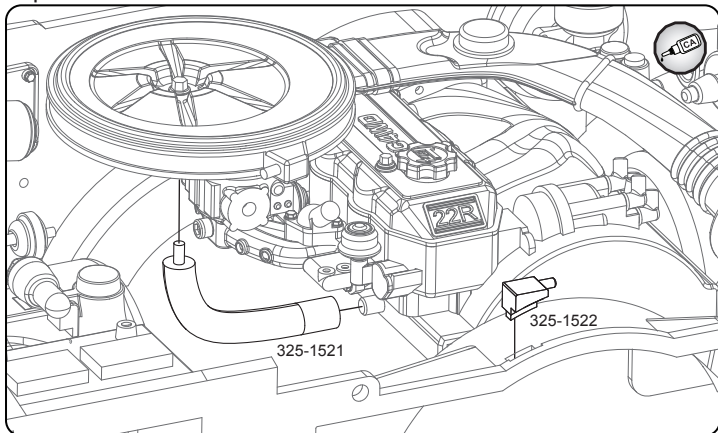



## RC4WD Yota 22R Engine Bay for 1982 Toyota Pickup

Step 23.

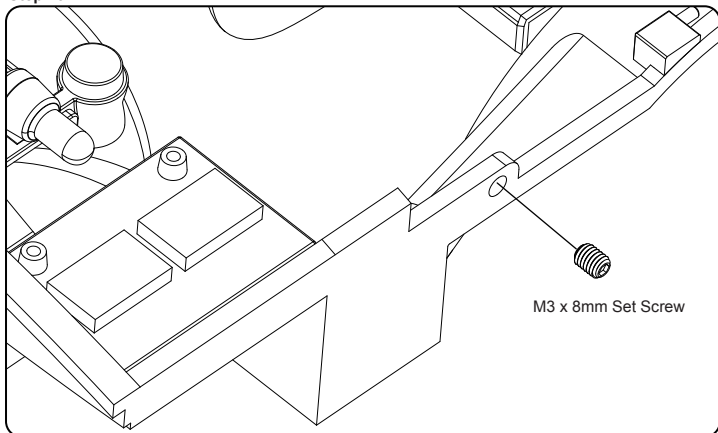

Step 24. *The length is for reference only.*

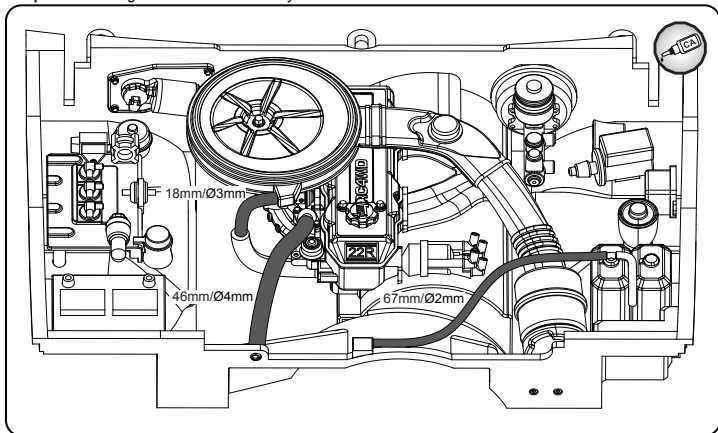



## RC4WD Yota 22R Engine Bay for 1982 Toyota Pickup

Step 25.

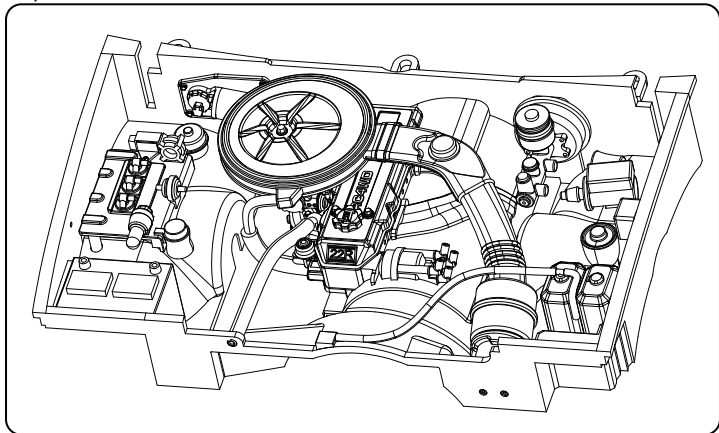

Step 26. DECAL INSTRUCTIONS.

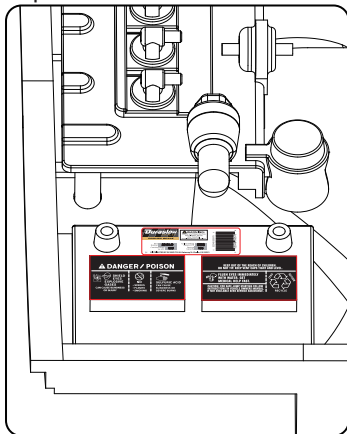

Step 27. DECAL INSTRUCTIONS.

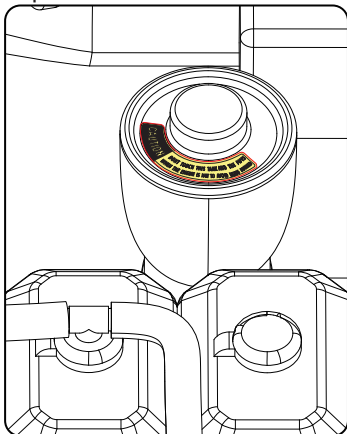



## RC4WD Yota 22R Engine Bay for 1982 Toyota Pickup

Step 28. DECAL INSTRUCTIONS.

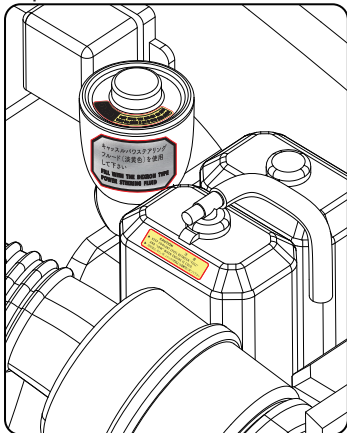

Step 29. DECAL INSTRUCTIONS.

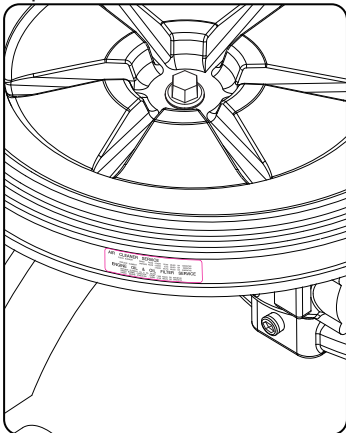

Step 30. DECAL INSTRUCTIONS.

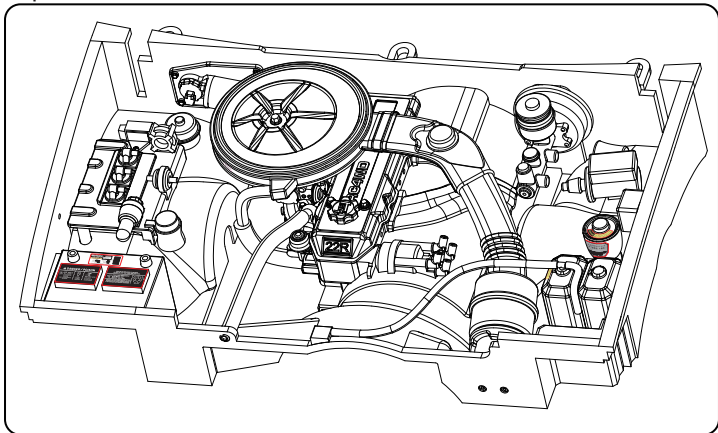



## RC4WD Yota 22R Engine Bay for 1982 Toyota Pickup

### Step 31. DECAL INSTRUCTIONS.

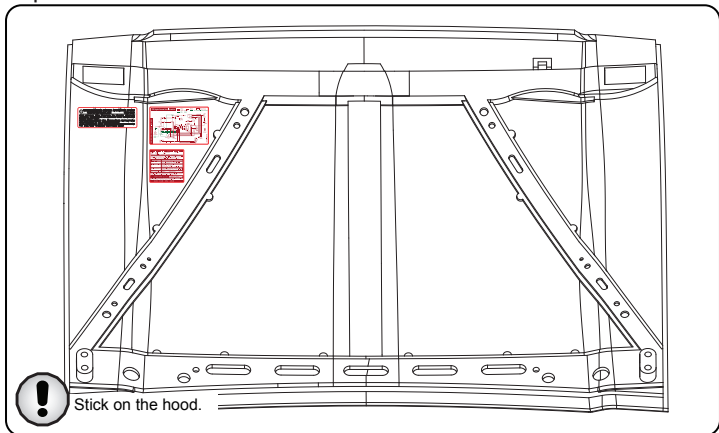

### Step 32. DECAL INSTRUCTIONS.

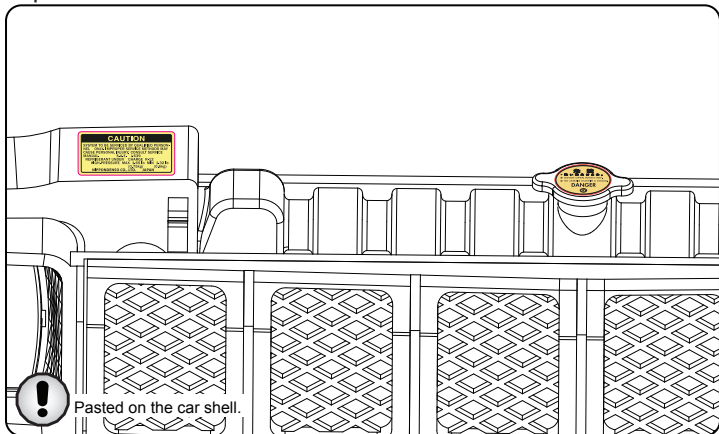



## RC4WD Yota 22R Engine Bay for 1982 Toyota Pickup

Step 33.

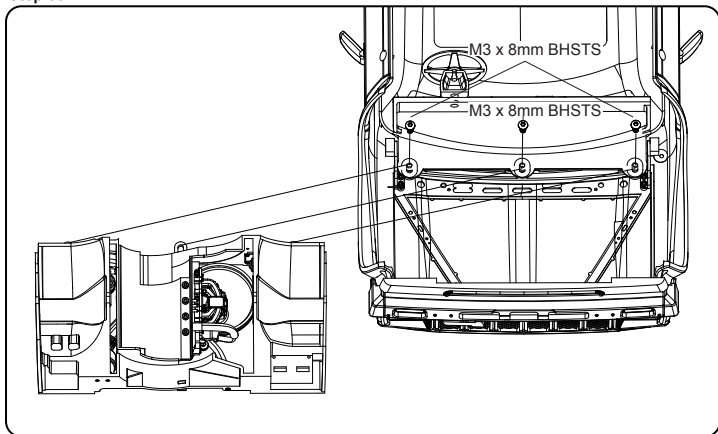

Step 34.

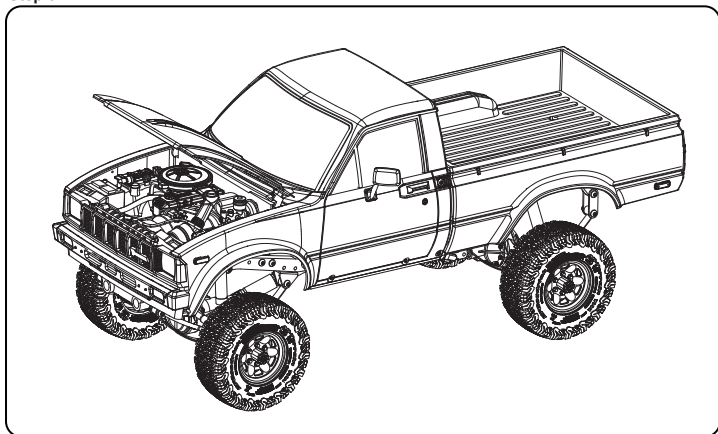



## RC4WD Yota 22R Engine Bay for 1982 Toyota Pickup

**Step 35.** Z-S0327 is not included in this kit.

Z-S0327 RC4WD Dress Up Kit for Yota 22R Engine Bay.

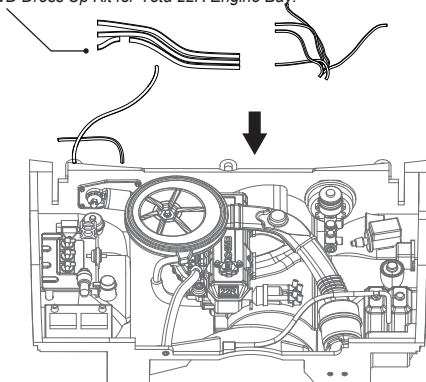

**Step 36.** Come and upgrade your RC4WD Yota 22R Engine Bay for 1982 Toyota Pickup !

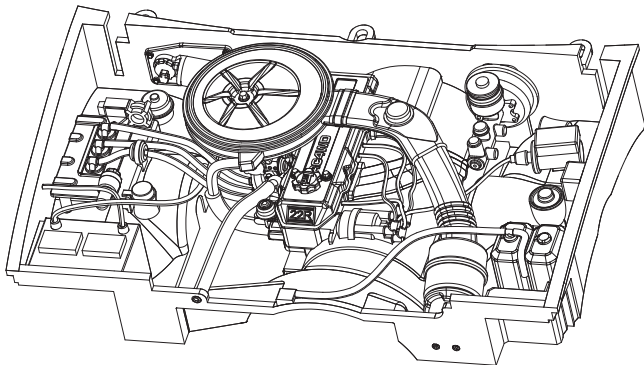



[www.rc4wd.com](http://www.rc4wd.com)



**RC4WD**

737 N. Gateway St.

Visalia, CA 93291

Web: [www.rc4wd.com](http://www.rc4wd.com) - Email: [support@rc4wd.com](mailto:support@rc4wd.com)

100-0137